

# LiftMaster Control Panel & Internet Gateway MyQ Bundle

Need help? Give us a call.  
1-877-826-5443

## Set Up Control Panel & Internet Gateway

### STEP 1

Disconnect power to the garage door.

### STEP 2

- Remove the existing door control from the wall.
- Note the polarity of the wires connected to the existing door control. Label the wires appropriately (Red/White).
- Disconnect the wires from the existing door control.
- Connect the wires to the new MyQ Control Panel.
- Mount the MyQ Control Panel to the wall.

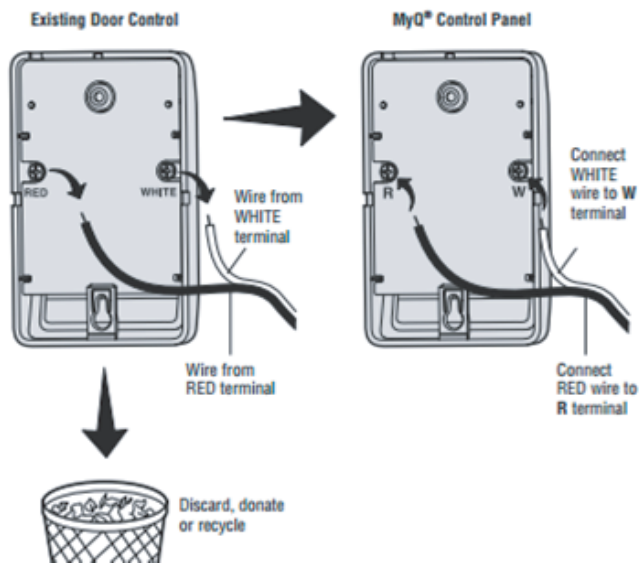

- Reconnect power. The yellow command LED (in the center of the MyQ Control Panel) and the red learn LED (above the learn button) will blink quickly for up to 5 minutes as the MyQ Control Panel recharges. When the MyQ Control Panel is operational, the yellow command LED will glow steadily.

**Note:** Refer to the included manual for troubleshooting if you are not seeing the yellow LED turn on.

- Test the MyQ Control Panel. Press the push bar to activate the garage door opener.

### STEP 3

Reconnect power to the garage door opener.

## Enroll Control Panel & Internet Gateway

### STEP 4

Connect the LiftMaster Internet Gateway to your Wi-Fi Router.

- **Note:** Green light indicates the Internet Gateway is plugged in and connected to the Internet.



### STEP 5

- Log into your alarm.com account via a web browser
- Click Settings in the menu on the left
- Select Devices
- Click LiftMaster Installation at the bottom right

### STEP 6

Follow website instructions to enroll the Garage Door Opener.

### STEP 7

Press the Learn button two times.



### STEP 8

Confirm connection to Internet Gateway.

- **Note:** Yellow light will be replaced by a blue light to confirm the opener is connected.



### STEP 9

Once enrollment is complete, test your LiftMaster garage door opener from you Alarm.com account or app.