

DWR20R-345

Recessed Door Sensor

Need help? Give us a call.
1-877-826-5443

Setup

The 2GIG-DW20R-345 is the industry's most flexible supervised recessed door/window contact, allowing a multitude of applications while hiding the transmitter within a door or window frame. The 2GIG-DW20R-345 uses a replaceable lithium battery and should last 5 years under normal usage.

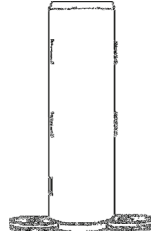

Box Contents

- Sensor
- Magnet
- 2 Screws
- 2 Magnet Caps

Test

Note: The sensor must be enrolled in the system before testing.

Before mounting the sensor, verify that the location provides good RF communication to the Control Panel. To verify, do the following:

1. From the **User Menu Toolbox**, select **System Test**.

2. Hold the magnet next to the removable cap on the sensor, then pull the magnet away from the sensor (open and close the DW20R). This action causes the Control Panel to chime and display the signal strength of the DW20R Sensor.

3. Exit the **System Test**.

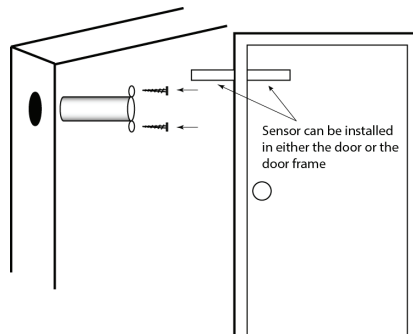

Intall and Mount

If possible, locate sensors within 80 ft. of the Control Panel.

Mounting Tools

- Drill
- 3/4" Drill Bit
- Marker or Pencil

It is important to select the proper placement of the recessed sensor/transmitter and magnet. The DW20R Sensor comes with two different tops, however, the screw mount is recommended for securing the sensor to a door frame. The magnet does not have a second top with a flange to screw it into place so you must be extremely careful to ensure that the magnet is tightly in place upon installation. To mount, do the following:

1. Mark the location on the door or window frame for the sensor/transmitter and magnet to be installed (use a marker or pencil). Ensure that the two holes you intend to drill are lined up directly across from each other (see figure on previous page).
2. Using an 3/4" drill bit, slowly drill the first hole for the transmitter. The DW20R Sensor is specifically designed to be slightly larger than an 3/4" hole. Drill carefully by slowly routing the hole little by little to ensure a snug fit. Use the flanged cap with the included screws to mount the transmitter to the door or window frame.
3. Drill a matching hole for the magnet, directly opposite from the transmitter, also using an 3/4" drill bit.